

ITEM: SLEEKLINE BALL END TURNBUCKLE

MATERIAL: TYPE 316 STAINLESS STEEL.

FITTING TYPE: ADJUSTABLE CABLE END TURNBUCKLE FOR ATTACHING & TENSIONING LINES. SMOOTH, ATTRACTIVE APPEARANCE WITHOUT ANY EXPOSED THREADS OR SWAGE ENDS.

SWAGE TYPE: CAN BE MACHINE SWAGED IN FACTORY BUT BEST SUITED FOR FIELD ATTACHMENT USING CABLECRIMP HAND SWAGE STYLE.

POST TYPE: METAL. WOOD POSSIBLE BUT NOT RECOMMENDED. (POSTS NOT INCLUDED).

FASTENING TO POST: ATTACH THROUGH END/TERMINATION POST HOLES USING A SCREW-ON BALL END.

FASTENING AT ANGLES: DRILL SLOTS OR ANGLED POST HOLES AND TURNBUCKLE WILL PIVOT ON BALL END.

CABLE TENSIONING: ADJUST BY TURNING TUBULAR TURNBUCKLE BODY.

HARDWARE PAIRINGS: USUALLY PAIRED WITH FIXED BALL END OR ANOTHER SLEEKLINE BALL END TURNBUCKLE. MAY ALSO USE ANY OTHER TENSION ADJUSTMENT FITTING OR FIXED END.

SUPPLIER: FEENEY ARCHITECTURAL PRODUCTS

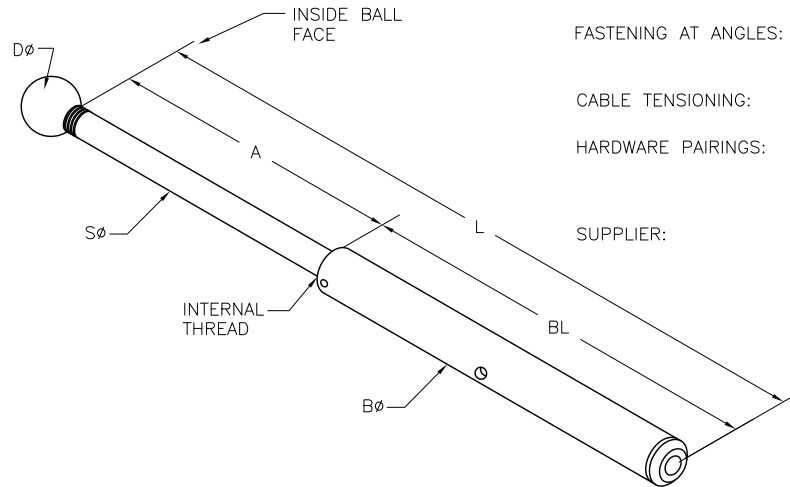

SLEEKLINE BALL END TURNBUCKLE, STAINLESS STEEL

PART#	SWAGE TYPE	CABLE SIZE	BALL END DIA (Dø)	SHAFT LENGTH CLOSED (OPEN) (A)	SHAFT DIA (Sø)	BODY LENGTH (BL)	BODY DIA (Bø)	LENGTH CLOSED (OPEN) (L)	*ATTACHMENT POST DRILL HOLE ø
3345	MACHINE	1/8"	5/8"	3-3/8" (5")	1/4"	4-3/4"	1/2"	8-1/8" (9-3/4")	5/16"
3346	MACHINE	3/16"	5/8"	3-3/8" (5")	1/4"	4-3/4"	1/2"	8-1/8" (9-3/4")	5/16"
3350	CABLECRIMP	1/8"	5/8"	3-3/8" (5")	1/4"	4-3/4"	1/2"	8-1/8" (9-3/4")	5/16"
3351	CABLECRIMP	3/16"	5/8"	3-3/8" (5")	1/4"	4-3/4"	1/2"	8-1/8" (9-3/4")	5/16"

* IF DESIRED THE BALL END CAN BE SLIGHTLY RECESSED INTO THE POST BY COUNTERBORING WITH A 9/16" DRILL

CableRail Reference Drawing:
SLEEKLINE BALL END TURNBUCKLE

THIS DRAWING IS THE PROPERTY OF FEENEY INC. ANY REPRODUCTION OF THIS DOCUMENT WITHOUT THE EXPRESSED WRITTEN CONSENT OF FEENEY INC. IS STRICTLY PROHIBITED.

DATE:	05/15/13
PAGE:	1 of 1
REV:	
BY:	DSY
CHK:	BWA

feeney
makes it easy
 2603 Union St., Oakland, CA 94607
 P: 800-888-2418 F: 510-893-9484
 www.feeneyinc.com